

TOF-PUSH PE Connection

IMPORTANT INSTALLATION INSTRUCTIONS

Follow each step carefully

STEP 1

Zetco Valves recommends the use of PE100 PN16 polyethylene pipes complying with AS/NZS 4130.

Cut pipe square and de-burr edges.



STEP 2

Loosen the brass nut and check that the internal components are present and in the correct position inside the valve or fitting:

1. Black rubber gasket
2. White reinforcing ring inside the wide rim of black gasket
3. White grab ring with solid end against black gasket

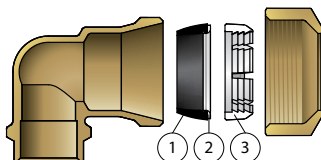

STEP 3

Secure the internal components by hand-fastening the nut. To ensure easy insertion of the pipe, do not over-tighten.

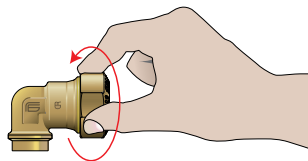

STEP 4

Push the pipe through the internal components, fully into the valve or fitting.

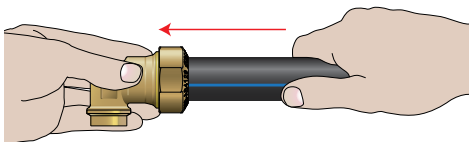

STEP 5

Fasten the nut securely with a ZETCO torque wrench or other suitable tool to the correct torque for your pipe size:

PE Pipe DN25	28Nm max. torque
PE Pipe DN32	32Nm max. torque

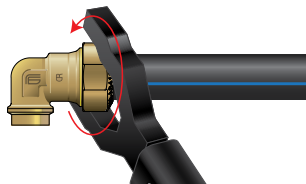

IMPORTANT WARNING

REMOVE THE NUT AND INTERNAL COMPONENTS

before brazing or soldering to prevent heat damage. Only PTFE sealing tape or an approved thread sealant such as Loxeal® should be used with threaded connections.

TEMP./PRESSURE	
Application	Water
Max. Temp.	60°C
Max. Pressure	1600kPa