



## Series 2805 & 2806

### Zetco Carbon Steel Needle Valve F&F

#### DESCRIPTION

A carbon steel needle valve with compact stainless steel T bar handle, designed for applications requiring a fine degree of flow control. Forged to shape and machined, the heavy pattern body with choice of either BSP or NPT threads provides excellent performance at high pressure and within a good working temperature range.

#### FEATURES

<b>Design</b>	<p>Forged to shape and machined from carbon steel</p> <p>Heavy pattern design for added durability</p> <p>Suitable for applications where fine control is required</p> <p>PTFE stem packing system to prevent leakage</p>
<b>Production</b>	<p>Manufactured in Taiwan (R.O.C.) under ISO 9001 QMS</p> <p>All valves are pressure tested during production</p>
<b>Technical</b>	<p>Female ISO 7/1 Rp (BSP) threaded connections (2805 Series)</p> <p>Female ANSI B1.20.1 (NPT) threaded connections (2806 Series)</p> <p>Flow control: Suitable for throttling and fine control</p> <p>Temperature range: 0°C to 200°C</p> <p>Max. pressure: 6000 PSI (41,300 kPa)</p> <p>Refer to graph for ratings at specific temperatures</p>
<b>Options &amp; Variants</b>	<p>Size range: DN6 (1/8") to DN25 (1")</p> <p>Series 2843 &amp; 2844 AGA Approved stainless needle valve BSPT/NPT</p> <p>Series 2803 &amp; 2804 non-tested stainless needle valve BSP/NPT</p> <p>Series 1725 WaterMarked bronze needle valve F&amp;F</p> <p>Series 1724 WaterMarked bronze 90° angle needle valve F&amp;F</p>

# Series 2805 & 2806

Zetco Carbon Steel Needle Valve F&F



## DIMENSIONAL AND COMPONENT DIAGRAM

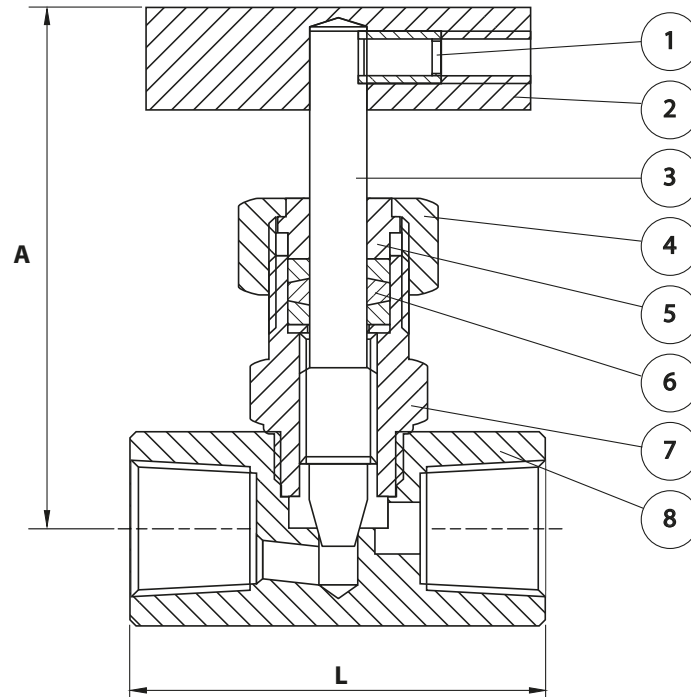

### PARTS MATERIALS

POS.	PART	MATERIAL
1	SET SCREW	STAINLESS STEEL 304
2	HANDLE	STAINLESS STEEL 410
3	STEM	STAINLESS STEEL 316
4	GLAND NUT	STAINLESS STEEL 304
5	GLAND	STAINLESS STEEL 304
6	PACKING	PTFE
7	BONNET	CARBON STEEL
8	BODY	CARBON STEEL

### DIMENSIONS (mm)

BSP	NPT	DN	Size - (mm)	A	B	C	L	Kv	Wgt Kg
2805003	2806003	6	1/8" - (3.1)	75	60	5	58	0.60	0.403
2805006	2806006	8	1/4" - (6.3)	75	60	5	58	0.69	0.383
2805010	2806010	10	3/8" - (9.5)	75	60	5	58	0.77	0.364
2805015	2806015	15	1/2" - (12.7)	87	60	6	65	1.03	0.568
2805020	2806020	20	3/4" - (19.0)	90	81	8	70	1.12	0.698
2805025	2806025	25	1" - (25.4)	103	81	8	80	1.55	1.28

### PRESSURE/TEMPERATURE GRAPH

