



## Series 2806

Carbon Steel  
Needle Valve  
NPT Threaded

### FEATURES

MANUFACTURED IN TAIWAN (R.O.C.)

HEAVY PATTERN DESIGN

CARBON STEEL

FORGED TO SHAPE AND MACHINED

SUITABLE FOR APPLICATIONS WHERE FINE FLOW CONTROL IS REQUIRED

ALL VALVES PRESSURE TESTED DURING PRODUCTION

SIZE RANGE: 6MM TO 25MM

### PRESSURE AND TEMPERATURE RATINGS

TEMPERATURE RANGE: 0°C TO 200°C

MAXIMUM OPERATING PRESSURE AT NOMINAL TEMPERATURES: 6000 PSI (41,300kPa)

FOR RATINGS AT SPECIFIC TEMPERATURES REFER TO GRAPH OVERLEAF

# Series 2806

Carbon Steel Needle Valve

NPT Threaded

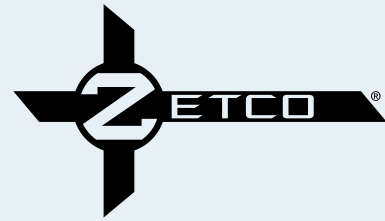

## DIMENSIONAL AND COMPONENT DIAGRAM

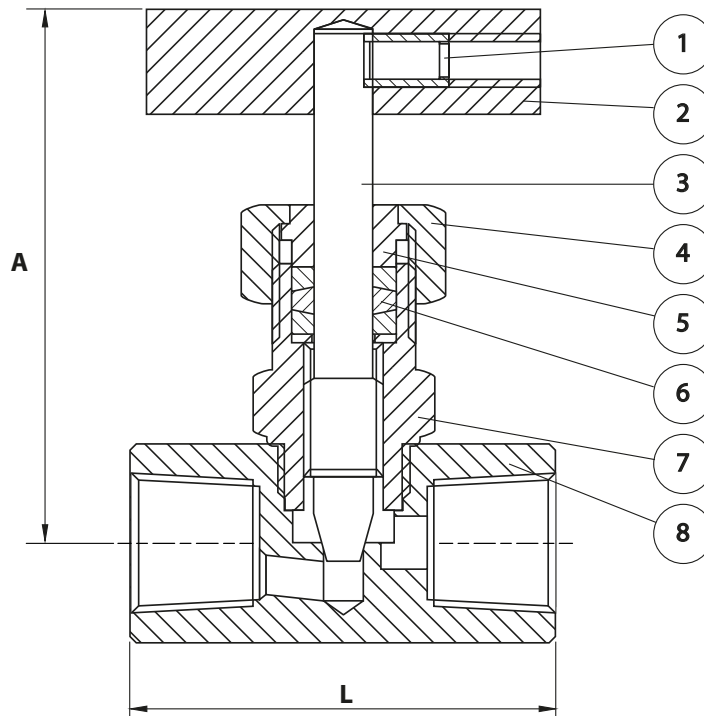

### MATERIALS

POS.	PART NAME	MATERIALS
1	SET SCREW	STAINLESS STEEL 304
2	HANDLE	STAINLESS STEEL 410
3	STEM	STAINLESS STEEL 316
4	GLAND NUT	STAINLESS STEEL 304
5	GLAND	STAINLESS STEEL 304
6	PACKING	PTFE
7	BONNET	CARBON STEEL
8	BODY	CARBON STEEL

### DIMENSIONS - mm

Prod. Code	Size	A	L	Kv	Wgt kg
2806003	3	75	58	0.60	0.403
2806006	6	75	58	0.69	0.383
2806010	10	75	58	0.77	0.364
2806015	15	87	65	1.03	0.568
2806020	20	90	70	1.12	0.698
2806025	25	103	80	1.55	1.28

### PRESSURE/TEMPERATURE DIAGRAM

