



Series 4055

Zetco WaterMarked Stainless Steel Swing Check Valve

DESCRIPTION

A high quality heavy pattern 316 grade stainless steel swing check valve WaterMark approved to AS 1628 (Licence WM-022953). This versatile swing check valve automatically closes as system pressure drops, preventing unwanted flow reversal, particularly in applications involving steam or where high flow capacity and superior corrosion resistance are required.

FEATURES

Design	<p>Investment cast body and disc in stainless steel 316 grade</p> <p>Suitable for use with steam</p> <p>Arrow on body indicates direction of flow</p> <p>Heavy pattern design for robust, reliable performance</p> <p>PTFE body seals for superior leak prevention</p>
Production	<p>Manufactured in China under ISO 9001 Quality Management System</p> <p>All valves are pressure tested during production</p>
Technical	<p>Female ISO 7/1 Rp threaded connection (BSP)</p> <p>Flow capacity: Full flow design in conformance with AS 1628</p> <p>Flow orientation: Horizontal or vertical</p> <p>Temperature range: -20°C to 200°C</p> <p>Max. pressure water: 3200 kPa @ 100°C (see graph page 2)</p> <p>Max. pressure steam: 850 kPa @ 175°C (see graph page 2)</p>
Options & Variants	<p>Size range: 15mm to 50mm</p> <p>Series 4050 Non-tested stainless steel swing check valve</p> <p>Series 1802 WaterMarked DZR brass swing check valve</p> <p>Series 1805 WaterMarked bronze swing check valve</p>

Series 4055

Zetco WaterMarked Stainless Steel
Swing Check Valve



DESCRIPTION

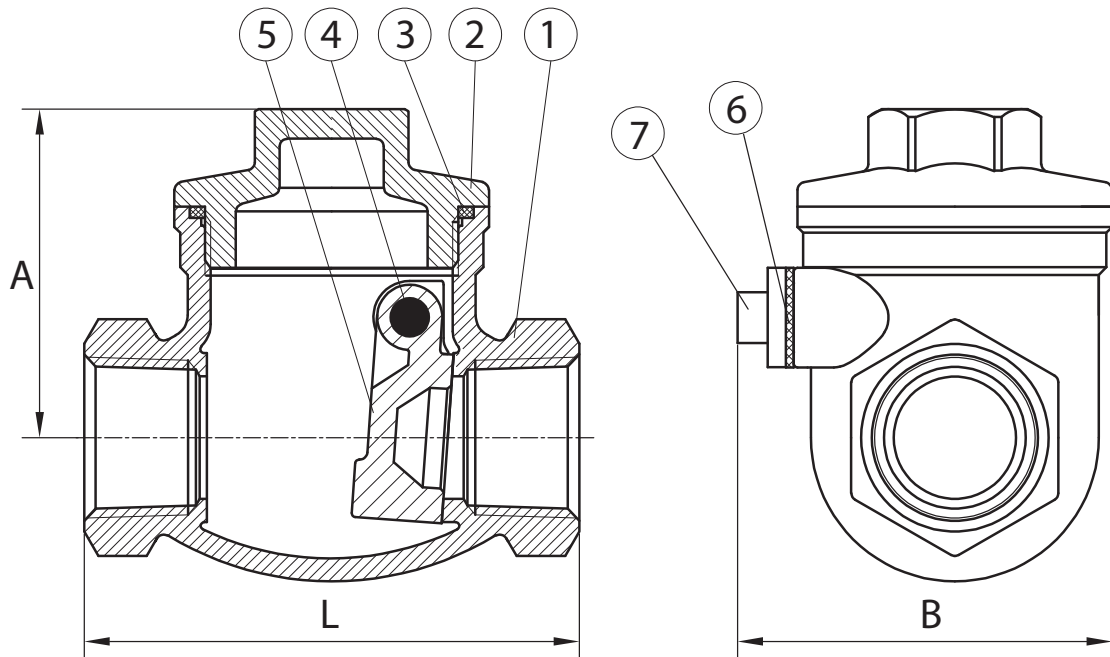

PARTS MATERIALS

POS.	PART	MATERIAL
1	BODY	STAINLESS STEEL 316
2	CAP	STAINLESS STEEL 316
3	GASKET	PTFE
4	HINGE PIN	STAINLESS STEEL 316
5	DISC	STAINLESS STEEL 316
6	PLUG WASHER	PTFE
7	STOPPER	STAINLESS STEEL 316

DIMENSIONS (mm)

Prod. Code	Size	A	B	L	Kv	Wgt Kg
4055015	15	43	46.5	65	30	0.300
4055020	20	51	51.5	80	65	0.440
4055025	25	60	56	89	103	0.690
4055032	32	66	64	105	145	1.02
4055040	40	75	74.5	120	217	1.56
4055050	50	80	84	139	334	2.14

PRESSURE/TEMPERATURE GRAPH

