



## Series 4090 & Series 4091

Stainless Steel  
High Pressure  
Ball Valve

### FEATURES

MANUFACTURED IN ITALY

STAINLESS STEEL 316

AVAILABLE WITH: ISO 7 THREADS - SERIES 4090  
ANSI/ASME B1.20.1 NPT THREADS - SERIES 4091

BLOW-OUT PROOF STEM

FULL BORE

MUST BE OPERATED IN FULLY OPEN OR CLOSED POSITION

ALL VALVES PRESSURE TESTED DURING PRODUCTION

SIZE RANGE: 6MM TO 65MM

### PRESSURE AND TEMPERATURE RATINGS

TEMPERATURE RANGE: -30°C TO 100°C

MAXIMUM OPERATING PRESSURE AT NOMINAL TEMPERATURES:

6MM TO 15MM: 50,000 kPa

20MM: 40,000 kPa

25MM TO 50MM: 35,000 kPa

65MM: 15,000 kPa

FOR RATINGS AT SPECIFIC TEMPERATURES REFER TO GRAPH OVERLEAF

# Series 4090 & 4091

## Stainless Steel High Pressure Ball Valve



### DIMENSIONAL AND COMPONENT DIAGRAM

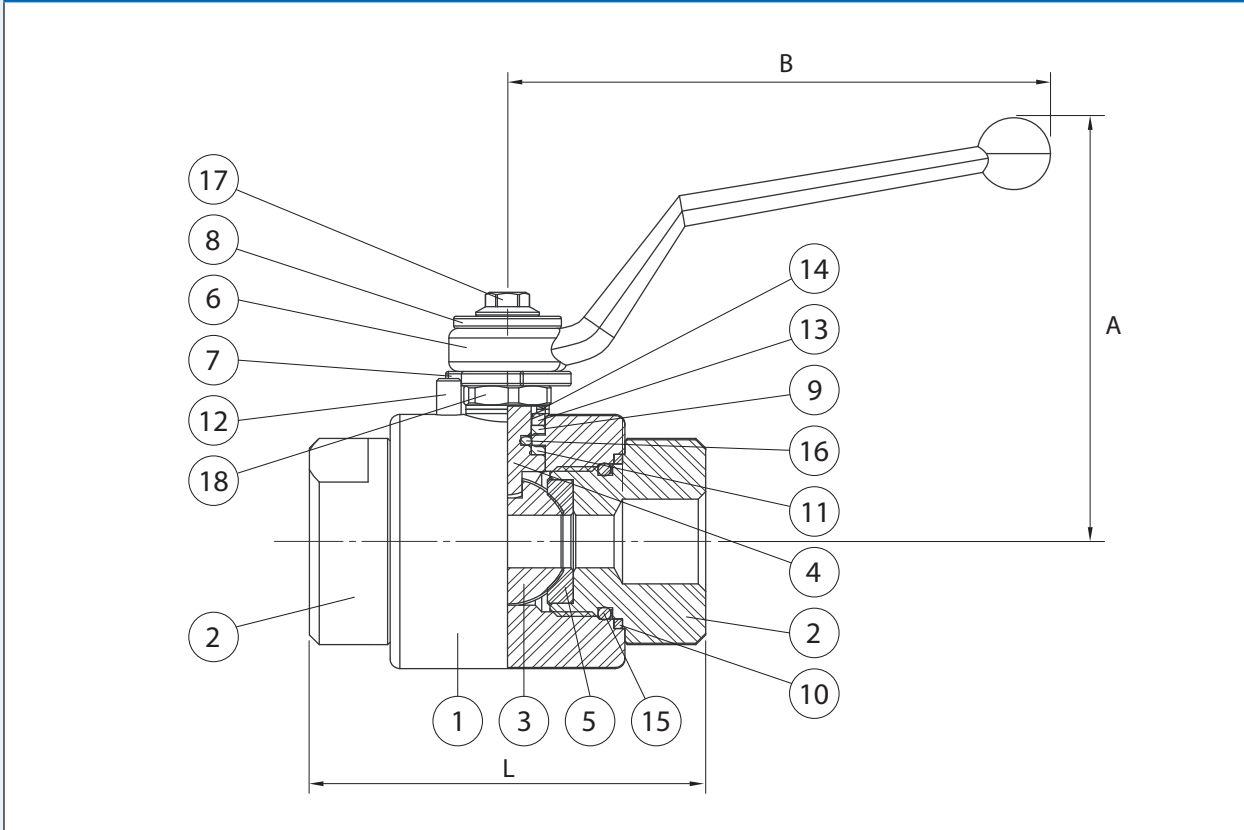

### MATERIALS

POS.	PART NAME	MATERIALS
1	BODY	STAINLESS STEEL 316L
2	END ADAPTOR	STAINLESS STEEL 316L
3	BALL	STAINLESS STEEL 316L
4	STEM	STAINLESS STEEL 316L
5	SEAL	PTFE
6	HANDLE	STEEL
7	WASHER	STAINLESS STEEL 304
8	WASHER	STAINLESS STEEL 304
9	BODY RING	GRAPHITE
10	ADAPTER RING	GRAPHITE
11	STEM RING	PTFE
12	SPINE	STAINLESS STEEL 304
13	PRESS RING	STAINLESS STEEL 304
14	SPRING	STAINLESS STEEL 304
15	ADAPTER O-RING	NBR
16	STEM O-RING	NBR
17	SCREW	STAINLESS STEEL 304
18	NUT	STAINLESS STEEL 304

### DIMENSIONS - mm

Code ISO 7	Code NPT	Size	A	B	L	Kv	Wgt kg
4090006	4091006	6	85	107	72	4.3	0.874
4090010	4091010	10	85	107	73	6.0	0.852
4090015	4091015	15	88	107	81	30.2	1.15
4090020	4091020	20	94	176	98	53.7	2.09
4090025	4091025	25	96	176	106	90.6	2.84
4090032	4091032	32	78	300	127	176.5	4.54
4090040	4091040	40	85	300	135	245.2	6.39
4090050	4091050	50	88	300	160	364.5	8.73
4090065	4091065	65	154	650	174	645.4	17.46

### PRESSURE/TEMPERATURE DIAGRAM

