



Series 6608

Zetco WaterMarked Female x TOF PE Connector

DESCRIPTION

A DZR brass connector with both a female thread and patented TOF PE connection WaterMark approved to AS/NZS 4129 (Licence WM-022080). The TOF PE connection allows for polyethylene pipes in potable water installations to be connected quickly and easily to fittings, pipe or equipment with a male threaded connection.

FEATURES

Design	Forged dezincification resistant brass single-piece body
Production	Manufactured in Italy under ISO 9001 Quality Management System
Technical	<p>Female ISO 7/1 Rp threaded connection</p> <p>EN 1254-3 compression connection for polyethylene pipes (PE)</p> <p>Suitable for use with PE pipes complying with AS/NZS 4130</p> <p>Flow capacity: Full bore</p> <p>Temperature range: -20°C to 60°C</p> <p>Max. pressure: 1600 kPa</p> <p>Must be installed according to accompanying instructions (see p. 4)</p>
Options & Variants	<p>Size range: PE25x20mm, PE32x25mm</p> <p>PE fittings: Series 6603 TOF PE Tee Series 6604 Male x TOF PE Connector Series 6605 TOF PE x TOF PE Joiner Series 6619 TOF PE x TOF PE Elbow Series 6606 Male x TOF PE Elbow Series 6620 Female x TOF PE Elbow</p> <p>Series 6610 Torque wrench (see p. 3)</p>

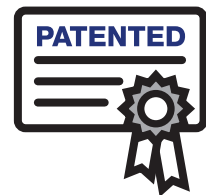

AUSTRALIAN PATENT
NUMBER 2012241556



WaterMark

IAPMO WM-022080
AS/NZ 4129

Series 6608

Zetco WaterMarked

Female x TOF PE Connector



DESCRIPTION

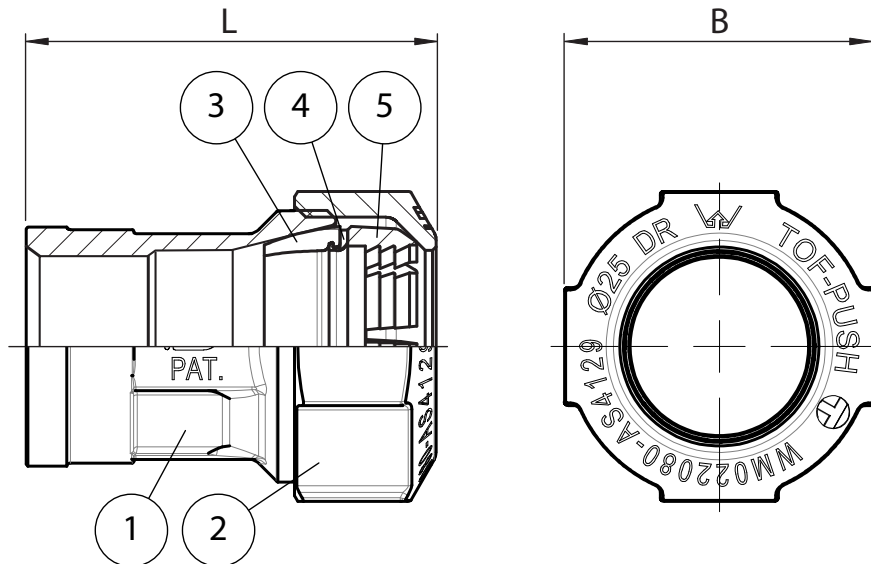

PARTS MATERIALS		
POS.	PART	MATERIAL
1	BODY	DZR BRASS
2	NUT	DZR BRASS
3	RUBBER GASKET	NBR
4	REINFORCING RING	ACETAL RESIN
5	COMPRESSION RING	ACETAL RESIN

DIMENSIONS (mm)				
Prod. Code	Size	B	L	Wgt Kg
6608001	PE25x20	42.2	55	0.161
6608003	PE32x25	50.4	59	0.235

Must be installed according to accompanying instructions, shown on page 4 and also for download at www.zetco.com.au



Series 6610

Zetco TOF PE Torque Wrench & Tools

DESCRIPTION

A quality torque wrench handle supplied with specially designed wrenching tools to enable easy and accurate tightening of PE25, PE32, PE50 and PE63 TOF PE nuts. Achieving the correct torque on the TOF PE nuts is essential for ensuring that the connection meets the standards required by AS/NZS 4129.

FEATURES

Design	<ul style="list-style-type: none"> Rotate dial to required torque and lock into place Solid 14x18mm head socket Easily interchangeable tools Each tool designed to exactly fit two sizes of TOF PE nuts Handle supplied in protective plastic case
Production	Manufactured in Taiwan under ISO 9001 Quality Management System
Technical	<ul style="list-style-type: none"> Torque range: 19Nm to 110Nm Accuracy: CW \pm 4% , CCW \pm 6% Refer to accompanying instructions for required torque (see p. 4)
Options	With PE25/PE32 tool only or PE25/PE32 & PE50/PE63 tools

ORDERING INFORMATION

Prod. Code	Product Description
6610003	Torque wrench handle with PE25/PE32 tool only
6610007	Torque wrench handle with PE25/PE32 and PE50/PE63 tools

TOF PE Connection

Installation Instructions



Australian Patent No. 2012 241 556



WaterMark
IAPMO WM-022080
AS/NZS 4129

TOF PE Connection

IMPORTANT INSTALLATION INSTRUCTIONS
Follow each step carefully

INSTALLATION INSTRUCTION SHEET

STEP 1

Remove the brass nut and check that the internal components are present and in the correct position inside the valve or fitting:

1. Black rubber gasket
2. White reinforcing ring inside the wide rim of black gasket
3. White grab ring with solid end against black gasket
4. Bushing sleeve removed (PE40-PE63 only)

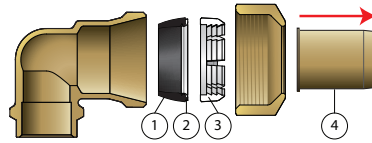

STEP 2

Zetco Valves recommends the use of PE100 PN16 polyethylene pipes complying with AS/NZS 4130.

Cut pipe square and de-burr edges.

For PE40 to PE63 only, insert bushing sleeve fully into pipe.

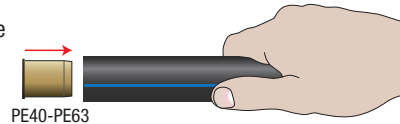

STEP 3

Secure the internal components by hand-fastening the nut.

To ensure easy insertion of the pipe, fasten nut loosely with a single turn and do not over-tighten.

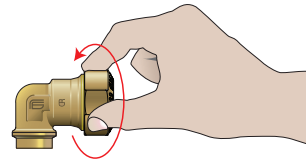

STEP 4

Push the pipe through the internal components, fully into the valve or fitting.

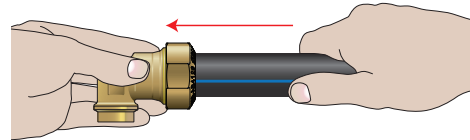

STEP 5

Fasten the nut securely with a ZETCO torque wrench to the correct torque for your polyethylene pipe size:

PE Pipe Size	25mm	32mm	40mm	50mm	63mm
Max. Torque	28Nm	32Nm	60Nm	100Nm	100Nm
with bushing sleeve					

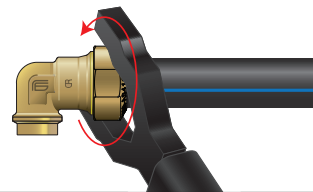

IMPORTANT WARNING

REMOVE THE NUT AND INTERNAL COMPONENTS

before brazing or soldering to prevent heat damage.
Only PTFE sealing tape or an approved thread sealant such as Loxeal® should be used with threaded connections.

TEMP./PRESSURE	
Application	Water
Max. Temp.	60°C
Max. Pressure	1600kPa

Disclaimer: Zetco Valves Pty Ltd will not accept responsibility for damage caused by failure to follow the instructions & warnings provided.
The most recent version of these instructions and additional technical information can be obtained at www.zetco.com.au

© 01-2021

Also available for download at www.zetco.com.au